

Name: _____ Date: _____

Kangaroo addition

Add two 2-digit numbers

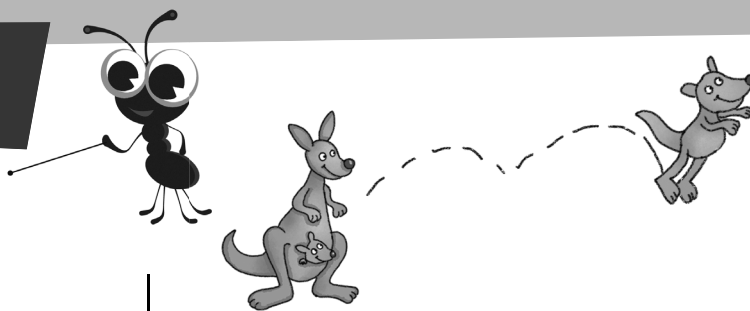

$$14 + 22 = \square$$

$\begin{array}{c} 14 \\ \swarrow \searrow \\ 10 \quad 4 \end{array}$

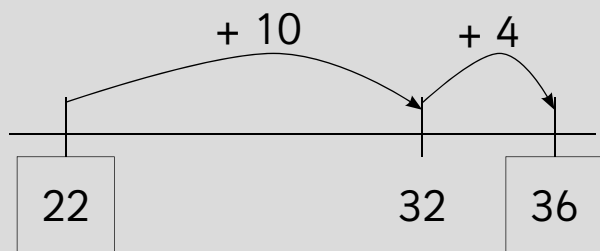

$$31 + 26 = \square$$

$\begin{array}{c} 26 \\ \swarrow \searrow \\ 20 \quad 6 \end{array}$

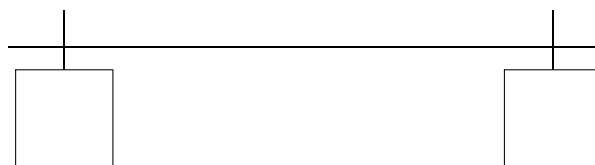

$$15 + 43 = \square$$

$\begin{array}{c} 15 \\ \swarrow \searrow \\ 10 \quad 5 \end{array}$

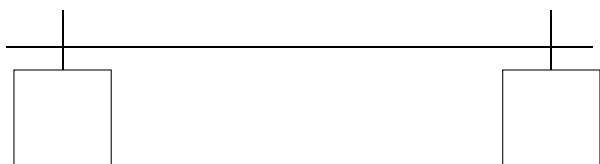

$$18 + 24 = \square$$

$\begin{array}{c} 18 \\ \swarrow \searrow \\ 10 \quad 8 \end{array}$

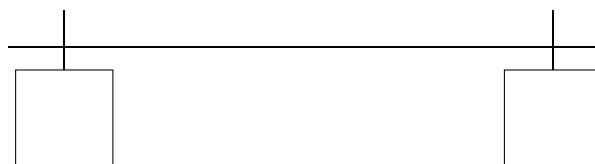

$$37 + 25 = \square$$

$\begin{array}{c} 25 \\ \swarrow \searrow \\ 20 \quad 5 \end{array}$

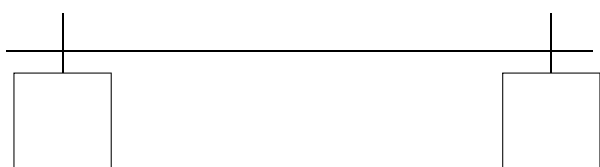

$$36 + 24 = \square$$

$\begin{array}{c} 24 \\ \swarrow \searrow \\ 20 \quad 4 \end{array}$

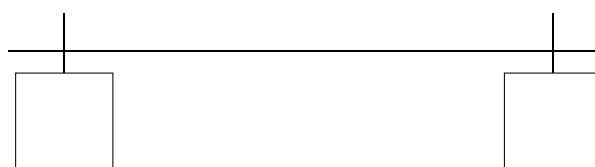

Teacher's notes

Children use the number line underneath each question to help them work out the answer. Remind the children to start with the larger number. For each question the smaller number has been partitioned into tens and ones to assist the children.